

# FGS. drill



*Siamo Produttori di...  
we manufacture...*





### ASTE DI PERFORAZIONE FORGIATE A FRIZIONE

Le aste di perforazione della F.G.S. Drill sono impiegate per la trivellazione di pozzi artesiani e nell'Ingegneria civile. Le aste di perforazione sono prodotte da tubi senza saldatura, con manicotti trattati, lavorati da acciaio 42CrMo4 bonificato. I manicotti sono filettati secondo specifiche API, e sottoposti a trattamento antigrippaggio. La durezza di detti manicotti è nel range 43\_48 HRC. I manicotti così realizzati, sono saldati al tubo con processo di forgiatura a frizione.

### FRICION WELDED DRILL PIPES

*F.G.S. Drill's friction welded drill pipes are manufactured to specifications that have been established for water well and mineral explorations.*

*F.G.S. Drill's pipes are fabricated from high quality seamless tube and tool joint machined from 42CrMo4 alloy steel and heat treated to HRC hardness range of 43\_48 HRC. All tool joints are accurately threaded to API specifications and heat treated to prevent galling during make-up. Tool joints are welded to pipes by friction welding process.*

THOMPSON 60 NEW



THOMPSON 60



# ASTE DI PERFORAZIONE FORGIATE A FRIZIONE FRICTION WELDED DRILL PIPES

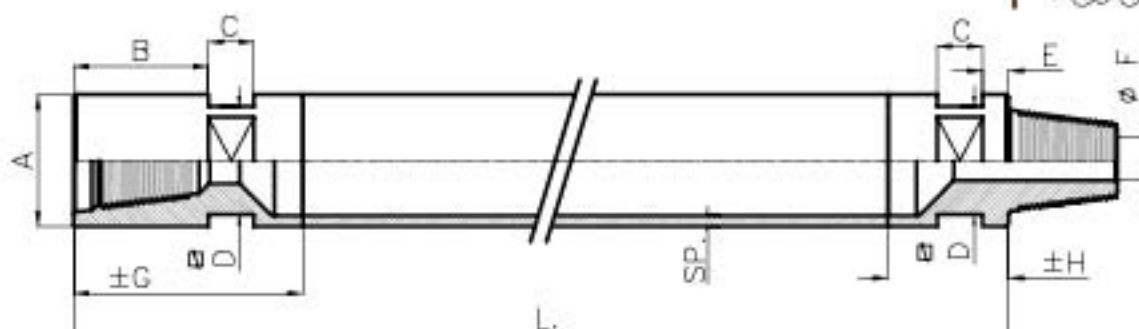

## ASTE STANDARD Standard drill pipes

Ø	SP/WT	Filettatura Thread	B	C	D	E	F	G	H	Ø	SP/WT	Filettatura Thread	B	C	D	E	F	G	H
42	6.3	REG. 42	57	40	35	12	15	134	89	90	4/6.3/8	2 3/8 I.F.	100	40	65	23.8	40	173	96
54	6.3	406RD	57	40	45	12	22	134	89	90	4/6.3/8	BR50	100	40	70	15	50	173	96
54	6.3	REG.45	57	40	45	12	25	134	89	101	6.3/8.8	2 7/8 I.F.	110	40	80	21.1	54	183	94
60	6.3	BWJ	80	40	50	29.2	20	163	112	101	6.3/8.8	2 7/8 REGULAR	110	40	80	21.1	30	183	94
60	6.3	506RD	80	40	50	10	30	134	89	114	5/6.3/8.8	2 7/8 I.F.	115	40	95	26.1	54	193	104
70	4	GG2	90	40	50	25.5	30	134	89	114	5/6.3/8.8	3 1/2 REGULAR	118	40	95	22.7	40	193	97
70	4	NWJ	85	40	55	15	30	173	103	114	5/6.3/8.8	3 1/2 FULL HOLE	118	40	95	22.7	60	193	97
70	4	506RD	60	40	50	15	30	163	98	114	5/6.3/8.8	3 1/2 I.F.	121	40	95	19.4	60	193	91
76	4/6.3	506RD	60	40	65	15	30	134	89	127	6.3/8.8	3 1/2 I.F.	119	40	105	17.4	60	213	111
76	4/6.3/8	BR45	90	40	65	15	45	173	96	140	6.3/8.8	4 1/2 REGULAR	130	40	110	22.05	60	223	115
76	4/6.3/8	238 MAYHEW JUNIOR	90	40	65	34	36	173	117	140	6.3/8.8	4 I.F.	132	40	110	17.7	80	223	108
76	4/6.3/8	2 3/8 REGULAR	90	40	65	13.8	30	173	96	140	6.3/8.8	4 1/2 FULL HOLE	140	40	110	3.8	76	223	121
90	4/6.3/8	2 3/8 REGULAR	100	40	65	23.8	30	173	96	152	8.8/10	4 1/2 REGULAR	130	40	110	22.05	60	223	115
90	4/6.3/8	2 7/8 REGULAR	105	40	65	16.1	30	173	83	152	8.8/10	4 1/2 I.F.	135	40	120	20.7	90	227	113

### Peso/weight kg L. 1500

Ø	Filatura/Thread	sp/wt 4	sp/wt 6.3	sp/wt 8
42	REG. 42		10	
54	406RD		13	
54	REG.45		13	
60	BWJ		16	
60	506RD		16	
70	GG2	13		
70	NWJ	13		
70	506RD	13		
76	506RD	17	22	
76	BR45	17	22	25
76	238 MAYHEW JUNIOR	17	22	25
76	2 3/8 REGULAR	17	22	25
90	2 3/8 REGULAR	21	27	31
90	2 7/8 REGULAR	21	27	31
90	2 3/8 I.F.	21	27	31
90	BR50	21	27	31
101	2 7/8 I.F.		30	37
101	2 7/8 REGULAR		30	37
114	2 7/8 I.F.	35	39	47
114	3 1/2 REGULAR	35	39	47
114	3 1/2 FULL HOLE	35	39	47
114	3 1/2 I.F.	35	39	47
127	3 1/2 I.F.		47	55
140	4 1/2 REGULAR		56	66
140	4 I.F.		56	66
140	4 1/2 FULL HOLE		56	66
152	4 1/2 REGULAR			71
152	4 1/2 I.F.			71

### Peso/weight kg L. 3000

sp/wt 4	sp/wt 6.3	sp/wt 8
	18	
	24	
	24	
	28	
	28	
22		
22		
22		
27	38	
27	38	44
27	38	44
27	38	44
33	45	53
33	45	53
33	45	53
33	45	53
33	45	53
52	66	
52	66	
54	63	80
54	63	80
54	63	80
54	63	80
73	92	
86	106	
86	106	
86	106	
115		
115		

### Peso/weight kg L. 6000

sp/wt 4	sp/wt 6.3	sp/wt 8
	35	
	46	
	46	
	53	
	53	
42		
42		
42		
48	70	
48	70	85
48	70	85
44	70	85
58	84	101
58	84	101
58	84	101
58	84	101
96	126	
96	126	
95	114	148
95	114	148
95	114	148
95	114	148
130	168	
148	191	
148	191	
148	191	
208		
208		

## MARTELLI FONDO FORO "KRYPTON" HAMMERS DOWN THE HOLE "KRYPTON"

I martelli fondo foro KRYPTON soddisfano le esigenze della clientela per l'ottimo rendimento nella perforazione di pozzi artesiani e nei lavori di consolidamento nelle opere civili. La F.G.S. Drill si pone nella continua ricerca di materiali e trattamenti termici idonei ad ottenere un elevato standard di prodotto. La F.G.S. Drill offre, inoltre, un capillare e puntuale servizio di assistenza post-vendita.

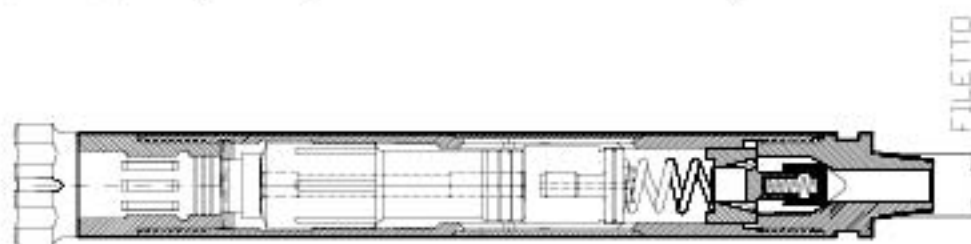

Modello Model	Ø Est. mm	Pressione Max Lavoro Max working Pressure	Consumo di aria Min. 10 Bar-18 Bar-24 Bar Lt/1' CFM	Filetto Thread	Lunghezza/mm Length/mm	Peso/Kg Weight/kg	Ø Foro/mm Hole/mm
KRYPTON 3	80	20 BAR	3800-10500	2 3/8 REG	780	30	92-105
KRYPTON 4	100	20 BAR	5800-12000-15500	2 3/8 REG	800	35	110-140
KRYPTON 5	122	20 BAR	9400-16000-22000	3 1/2 REG	1090	60	140-165
KRYPTON 6	146	24 BAR	11500-17000-24000	3 1/2 REG	1185	100	160-203
KRYPTON 7	153	24 BAR	11700-18500-27000	3 1/2 REG	1185	110	170-220
KRYPTON 8	186	24 BAR	13000-24000-31500	4 1/2 REG	1430	155	216-254
KRYPTON 12	262	27 BAR	28000-48500-XXXX	6 5/8 REG	1800	500	312-432

## AMMORTIZZATORI SHOCK ABSORBERS

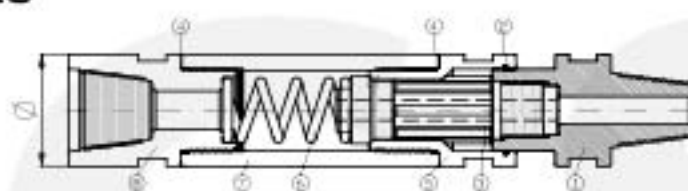

Cod. articolo Item	diam. Ø	Lunghezza Length	Peso Weight	Filetto Thread
AMM. 80*	80	± 540	± 15	2 3/8 REGULAR
AMM. 95*	95	± 540	± 22	2 3/8 REGULAR
AMM. 115...	115	± 750	± 50	3 1/2 REGULAR
AMM. 140...	140	± 760	± 65	3 1/2 REGULAR
AMM. 160...	160	± 780	± 86	3 1/2 REGULAR
AMM. 180...	180	± 795	± 100	4 1/2 REGULAR
AMM. 200...	200	± 795	± 140	6 5/8 REGULAR
AMM. 220...	220	± 795	± 180	6 5/8 REGULAR
AMM. 260...	260	± 795	± 230	6 5/8 REGULAR

POS	Denominazione Description
1	RACCORDO SUP.
2	O-RING INT. AVANCILINDRO
3	ALBERO
4	O-RING EST. AVANCILINDRO
5	AVANCILINDRO
6	MOLLA
7	CILINDRO
8	RACCORDO INF.

## PESCANTI FISHING TOOLS

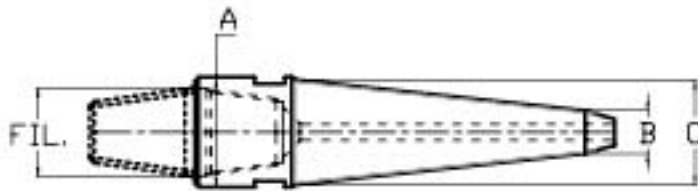

Overshots with female or male thread

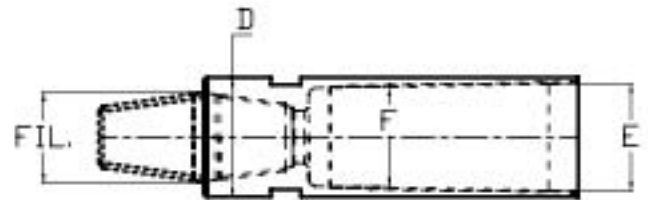

Taper Taps with female or male thread

Filettatura Thread	Ø = diameter					
	A	B	C	D	E	F
406RD	60	18	58	75	64	48
2 3/8 REGULAR	76	26	74	95	80	64
2 3/8 I.F.	90	26	88	114	94	78
2 7/8 I.F.	101	50	99	125	105	89
3 1/2 REGULAR	114	36	100	135	118	102
3 1/2 I.F.	127	56	123	145	131	115
4 1/2 REGULAR	140	56	136	155	144	128
4 1/2 I.F.	152	86	148	170	156	140

## TESTINE DI SOLLEVAMENTO HOISTING PLUGS



Filettatura / Thread				A	B	M	kg
76	2 3/8 REG.	20	1200				
90	2 3/8 REG.	24	1800				
90	2 3/8 I.F.	24	1800				
101	2 7/8 I.F.	24	1800				
114	3 1/2 REG.	27	2500				
127	3 1/2 I.F.	27	2500				
140	4 1/2 REG.	27	2500				
168	4 1/2 I.F.	30	3200				
180	6 5/8 REG.	33	4200				
200	7 5/8 REG.	36	4600				



## STABILIZZATORI STABILIZERS

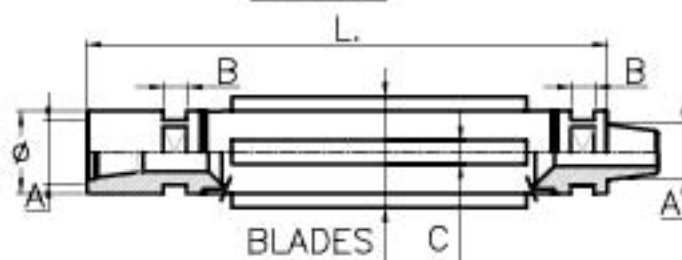
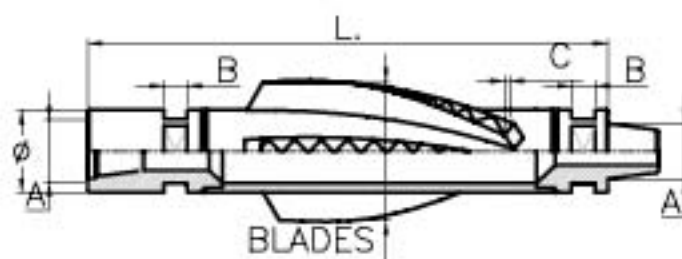
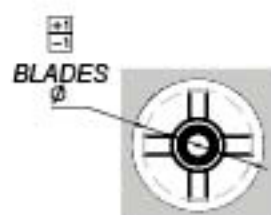
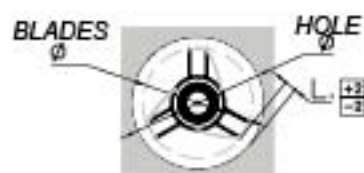

A	Ø	B	C	D
2 3/8 REGULAR	76	40	74	95
2 3/8 I.F.	90	40	88	114
2 7/8 REGULAR	90	40	30	30
2 7/8 I.F.	101	40	99	125
3 1/2 REGULAR	114	40	100	135
3 1/2 I.F.	127	40	123	145
4 1/2 REGULAR	140	40	136	155

A	Ø	B	C	D
4 1/2 FULLHOLE	140	40	40	60
4 1/2 I.F.	152	40	40	90
6 5/8 REGULAR	180	50	50	90
7 5/8 REGULAR	200	50	50	100
8 5/8 REGULAR	254	50	50	120
8 5/8 REGULAR	273	50	50	120

## ASTONI DRILL COLLARS

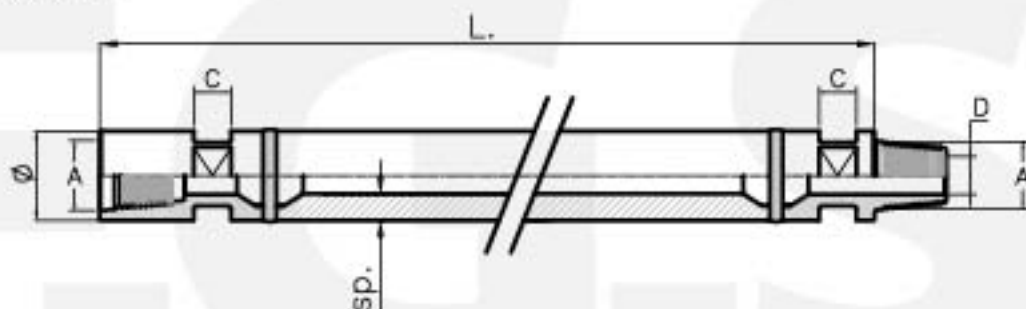

A	Ø	C	D
2 3/8 REGULAR	76	40	30
2 3/8 I.F.	90	40	40
2 7/8 REGULAR	90	40	30
2 7/8 I.F.	101	40	54
3 1/2 REGULAR	114	40	40
3 1/2 I.F.	127	40	40

A	Ø	C	D
4 1/2 REGULAR	140	40	60
4 1/2 I.F.	152	40	90
6 5/8 REGULAR	180	50	90
7 5/8 REGULAR	200	50	100
8 5/8 REGULAR	254	50	120
8 5/8 REGULAR	273	50	120

## ASTE SPECIALI SPECIAL DRILL PIPES

### DOUBLE KEY

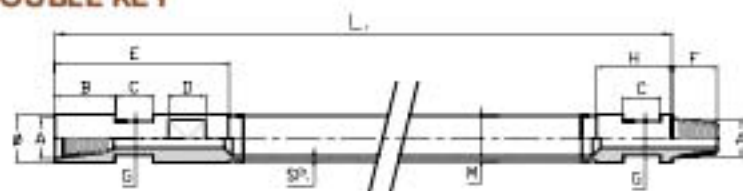

### CRAELIUS



### SMOOTH

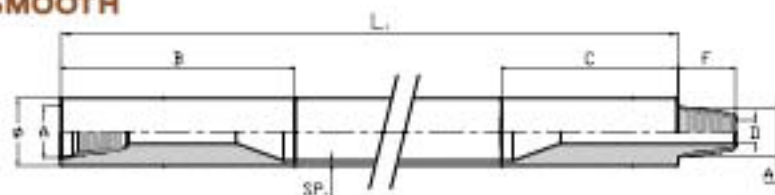

### HAUSHERR

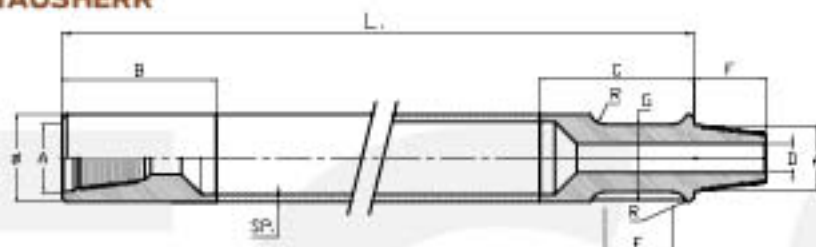

### T4 (RD20)

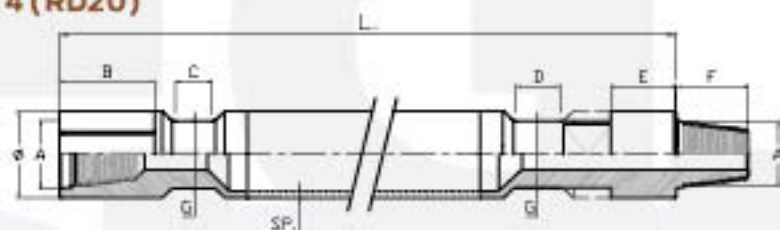

### UPSET



## TUBI DI MANOVRA CASINGS

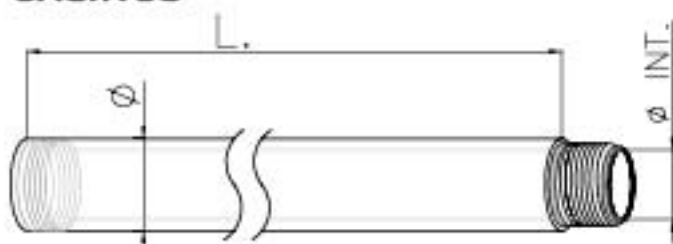

**MATERIALE TUBO/**Material tube: E355/N80

**MATERIALE MANICOTTO:** 42CrMo4 Bonificato  
Material Tool Joint: 42CrMo4 Quenched and tempered

Ø est. mm	Ø Int. mm	Spessore tubo centrale Central WT Tube	Lunghezze/mt - Peso/kg Length/mt - Weight/kg			
			1,00mt	1,50 mt	2,00mt	3,00mt
90	70	6,3 mm	13	20	26	40
101	81	8 mm	14	22	29	44
114	94	8 mm	24	35	48	69
127	105	8 mm	26	39	52	77
140	120	8,8 mm	30	44	60	86
152	132	8,8 mm	32	47	63	94
168	148	8,8 mm	36	53	72	105
178	158	8,8 mm	38	56	76	110
194	172	8,8 mm	41	61	82	121
203	178	8,8 mm	44	65	88	128
219	197	8,8 mm	47	70	94	132
244	222	10 mm	58	87	146	174
273	248	10 mm	65	97	130	195
300	275	10 mm	73	109	146	216

## CORONE CROWNS

Ø	Ø int. mm	Ø est. mm
101	93	117
114	93	117
127	105	130
133	113	134
140	119	143
152	131	155
168	146	170
178	157	180
194	172	195
203	178	204
219	196	222
244	222	246
273	248	274
300	275	300

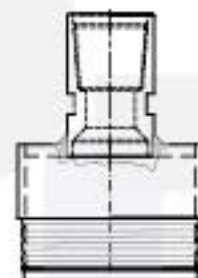
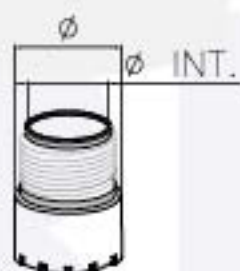
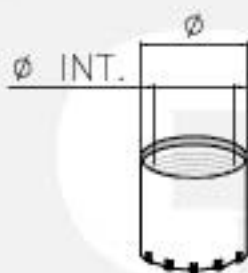



## RACCORDI SUBS

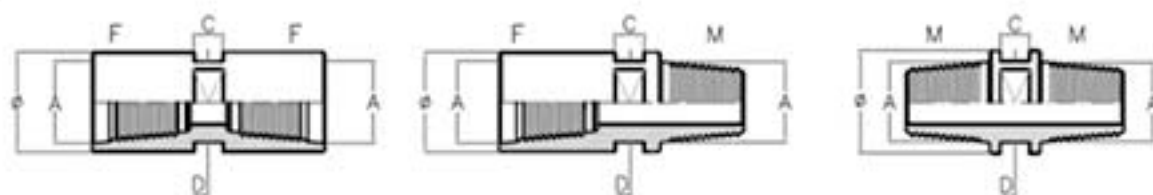

Ø	A	C	D
42	REG42	35	40
54	40-6-RD	40	45
60	50-6-RD	40	50
76	2 3/8 REGULAR	40	65
90	2 3/8 I.F.	40	65
90	2 7/8 REGULAR	40	65
101	2 7/8 I.F.	40	80
114	3 1/2 REGULAR	40	95

Ø	A	C	D
127	3 1/2 I.F.	40	105
140	4 1/2 REGULAR	40	110
140	4 1/2 FULLHOLE	40	110
152	4 1/2 I.F.	40	120
180	6 5/8 REGULAR	50	160
200	7 5/8 REGULAR	50	180
254	8 5/8 REGULAR	50	230
273	8 5/8 REGULAR	50	250

## VALVOLA NON RITORNO NO RETURN VALVE

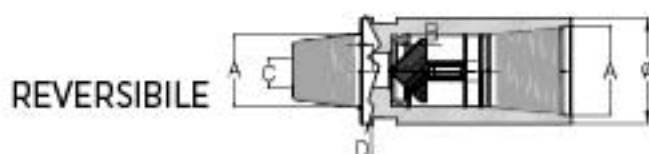

Ø	A	B	C	D
76	2 3/8 REGULAR	40	30	65
90	2 3/8 I.F.	40	40	65
90	2 7/8 REGULAR	40	30	65
101	2 7/8 I.F.	40	54	80
114	3 1/2 REGULAR	40	40	95
127	3 1/2 I.F.	40	60	105
140	4 1/2 REGULAR	40	60	110

Ø	A	B	C	D
140	4 1/2 FULLHOLE	40	60	110
152	4 1/2 I.F.	40	90	120
180	6 5/8 REGULAR	50	90	160
200	7 5/8 REGULAR	50	100	180
220	8 5/8 REGULAR	50	120	200
273	8 5/8 REGULAR	50	120	250

## CHIAVE SMONTAGGIO KEY

Asta Ø	A	B	C	D	E	SP.
54	46	120	388	250	40	30
60/70	51	140	388	250	40	30
76/90	66	208	566	300	50	35
101	81	210	640	400	50	35
114	96	196	656	420	60	35
127	106	206	583	420	80	35
140	111	231	620	410	80	35
152	121	241	620	410	80	35

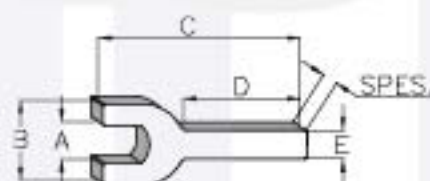

## ASTE ELICOIDALI/AUGERS CON ATTACCO ESAGONALE O FILETTATO

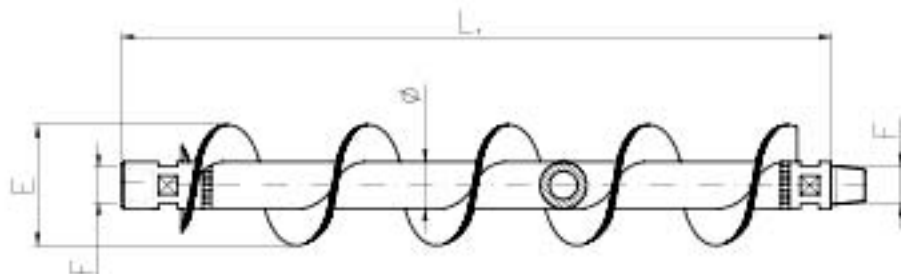

Diametro	Dimen. tubo	Passo	Spessore spirale	Attacco filettat./esagon.
100	60X8	100	7	MF NC-FFM41
115	60X8	100	7	MF NC-FFM41
125	60X8	125	7	MF NC-FFM 41
150	76X8	150	8	2" <sup>3/8</sup> MF-FFM50
180	76X8	200	8	2" <sup>3/8</sup> MF-FFM50
180	88.9X8	200	8	2" <sup>3/8</sup> MF-FFM60
200	76X8	200	8	2" <sup>3/8</sup> MF-FFM50
200	88.9X8	200	8	2" <sup>3/8</sup> MF-FFM60
220	76X8	200	10	2" <sup>3/8</sup> MF-FFM50
220	88.9X8	200	10	2" <sup>3/8</sup> MF-FFM60
250	88.9X8	250	10	2" <sup>3/8</sup> MF-FFM60
300	114X8,8	250	10	3" <sup>1/2</sup> MF-FFM70



### TRILAMA/DRAG BIT



Sono utilizzati nella perforazione di terreni poco consolidati (argille, marne).

*Are used to drill unconsolidated formations (shales, marls).*

### CLAW BIT



Sono utilizzati nelle perforazioni ghialose nelle marne.

*Are used to drill chert, graved shales and generally all formations averagely consolidated.*

### TRICONI/ TRICONE



A denti per formazioni tenere come argille, calcari. A inserti per formazioni rocciose, calcari duri, arenarie.

*With teeth to drill soft formations such shales, clay, with insert for hard formations such us hard limestone, sandstone.*

**PER IDENTIFICARE I FILETTI  
THREAD'S TECHNICAL DATAS**

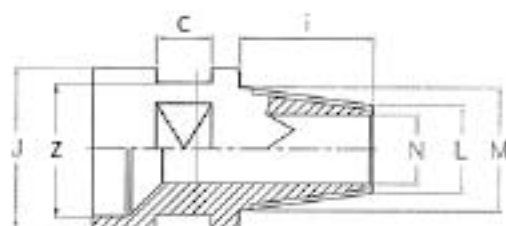

J	FILETTO	C	Z	I	L	M	N
76	23/8 REGULAR	40	65	76,2	47,61	66,67	30
90	23/8 I.F.	40	65	76,2	60,34	73,05	40
90	27/8 REGULAR	40	65	88,9	53,97	76,209	30
114	31/2 REGULAR	40	95	95,25	65,07	88,9	40
114	27/8 I.F.	40	95	88,9	71,32	86,131	50
114	31/2 FULL HOLE	40	95	95,25	77,62	101,447	55
127	31/2 I.F.	40	105	101,6	85,06	102,006	60
140-152	41/2 REGULAR	40	110	107,95	90,47	117,475	60
140-152	4 I.F.	40	110	114,3	103,73	122,78	80
140-152	37/8 I.F.	40	110	110	93,86	112,2	55
140-152	4 FULL HOLE	40	110	114,3	89,66	108,712	55
140-152	41/2 FULL HOLE	40	110	101,6	96,32	121,716	55
160	41/2 I.F.	40	140	114,3	114,3	133,35	80
180	65/8 REGULAR	40	160	127	131,04	152,196	90
200	75/8 REGULAR	40	180	133,35	144,46	177,80	90
250	85/8 REGULAR	40	220	136,525	167,84	201,988	120

LA **QUALITA'**  
È IL NOSTRO  
**PRODOTTO**

*QUALITY IS OUR PRODUCT*



ASTE DI PERFORAZIONE  
FORGIATE A FRIZIONE



Via dei Gerani, 36  
70026 Modugno - Bari (ITALY)  
Tel. +39 080.531.11.11  
Fax +39 080.530.80.07  
[www.fgsdrill.it](http://www.fgsdrill.it) | [info@fgsdrill.it](mailto:info@fgsdrill.it)

